

Kingspan Water Tanks

Owner's Manual for

Above Ground Water Tanks



Experts In
Steel Tanks



Congratulations on the purchase of your Kingspan Steel Water Tank

TABLE OF CONTENTS

System Overview	2
Care and maintenance of your system	3–7
Water pump + switch	8
Evolution MkIV tank mounted system	9
Fault finding	10
Service record & Warranty	11



Kingspan Water & Energy

– Sustainable steel water tanks.

Made to measure. Made to last.

Your home is now fitted with a complete water storage and rainwater harvesting system. This system collects water from the roof and stores it in your rainwater tank for later use in flushing your toilets, feeding your washing machine and one or more external taps for gardening use.

The rainwater storage tank fitted to your home has been proven to save over 70 000 litres of water per year on the average sized home and family. This is a significant benefit to the environment and a savings on your water bill.

The system is made up of a number of components and like many items around your home requires ongoing care and maintenance.

Please take the time to read and understand the contents of this user manual to ensure you get the best performance from your Kingspan system.



REMEMBER TO:

Register your water tank online at kingspanwatertanks.com.au/register-tank-and-pump-warranty/ and please let us know if your details change.

Should you require further assistance please visit kingspanwatertanks.com.au or call **1300 736 562** nationally.

System Overview

Your complete water storage and rainwater harvesting system comprises of the following elements:

1

Gutters to capture the rain from your roof

The gutters on your house capture rainwater running off your roof. These gutters direct the rainwater to the downpipes, which in turn feed into the rainwater collection tank. It is important that these gutters are kept clean and in good order.

2

Pipe work to feed rainwater into your tank

There are two main types of pipe work systems to feed the water to your collection tank:

- i. **Charged or wet system** (pictured below) - connects most of the down pipes around your home into an underground pipe work system that then feeds into your rainwater tank. You have this type of system if there is pipe work coming out of the ground next to your tank and feeding into the top, or side, of your tank.
- ii. **Direct feed system** - has the downpipe from the gutter setup to feed directly into your rainwater tank.

3

Rainwater collection

The rainwater tank collects and stores the water. Tanks vary in size and shape depending on the requirements of local council and building authorities. Your Kingspan tank is manufactured from Bluescope AQUAPLATE® material and carries a 10/20 warranty - 10 year construction warranty and 20 year warranty against corrosion. On some occasions your builder may have installed more than one tank on your home. These will normally be connected together and will act as one storage tank.

As the manufacturers, Kingspan recommends a 3 year tank service

A Kingspan service technician will inspect and carry out the following:

- Pump pre-warranty expiry inspection
- Checking the functionality of the pump
- A tank desludge (at the 3, 6, 12, and 15 year mark)
- Sanitised tank clean (at the 9 and 18 year mark)
- Cleaning of all filters including:
 - High-flow filter (if applicable)
 - Odour/sediment filters
 - Pump filter
 - Leaf basket
 - First flush filter
- Tank and tank base structure, which includes checking for leaks
- Cleaning of charge lines
- Cleaning of the outside of the tank

Don't worry, we'll remind you when the time comes.

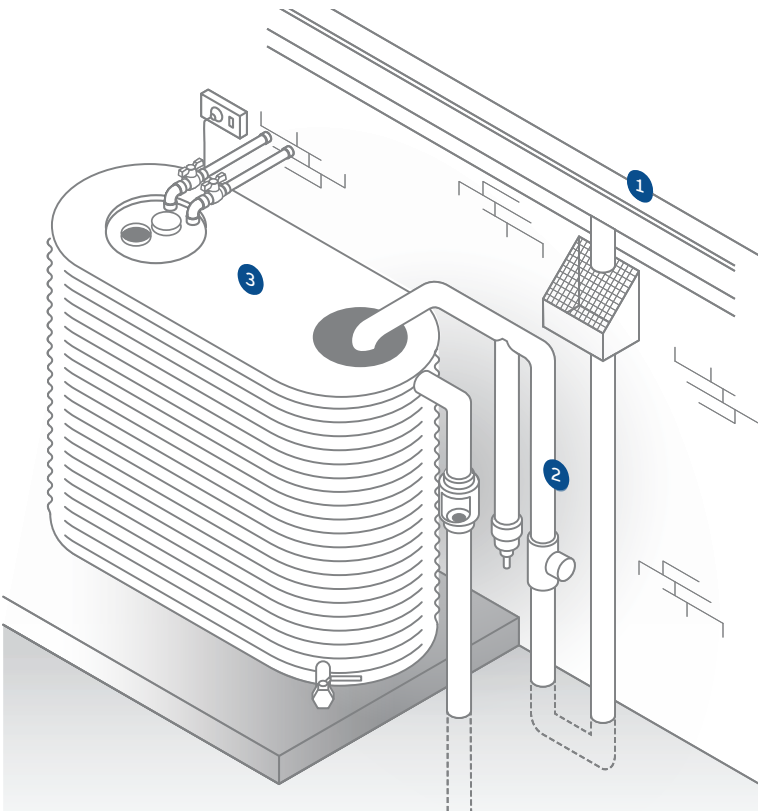

Care and maintenance of your system

Your water storage and rainwater harvesting system will provide many years of faultless operation with regular care and maintenance. It is important that the following care and maintenance is regularly performed.

Cleaning and inspecting your gutters

It is important for the proper functioning of your rainwater system that your gutters are kept clean and clear. Regular inspection and cleaning is required to ensure that leaves and other organic material does not enter your down pipes and collect in the underground pipe work.

If you live in a leafy area it is recommended that you fit a suitable gutter guard to help keep the leaves out of your gutters. Dirty gutters are the main cause of your rainwater developing an unpleasant odour, or becoming discoloured.

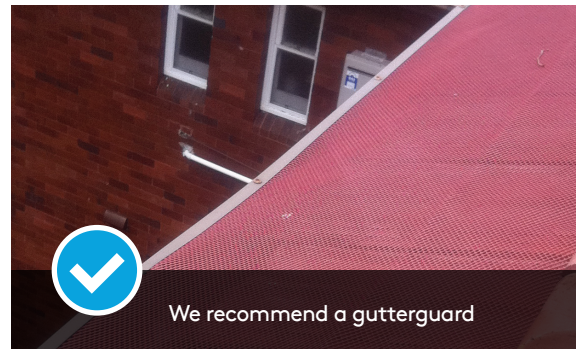

NOTE: Cleaning your gutters is a dangerous activity. We recommend the use of licensed contractors to perform this function.

Cleaning the tank inlet filter

The inlet filter to your tank must be kept clean, allowing the water from your roof to pass easily into your tank. Cleaning frequency of the inlet filter

varies depending on your location and the amount of debris coming from the roof. Initially, check the filter weekly until you determine the frequency required.



ACTION: Remove the filter and hose clean. The use of a scrubbing brush may be required to remove stubborn or dried on debris.

Care and maintenance of your system

Cleaning a High-Flow filter (if fitted)

If your tank is fitted with a High-Flow filter system, to maintain and clean the High-Flow filter is simple and requires you to access the stainless steel sediment control screen located inside the Inlet. This should be kept clean on a regular basis to ensure the water from your roof passes easily into your tank. Cleaning frequency of the stainless

steel sediment control screen will vary depending on the location of the tank and the amount of debris coming from the roof. Initially it is recommended that you check the stainless steel sediment control screen weekly until you determine the cleaning frequency that is required.

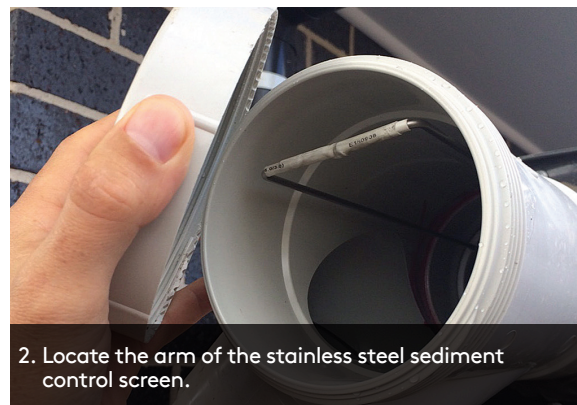
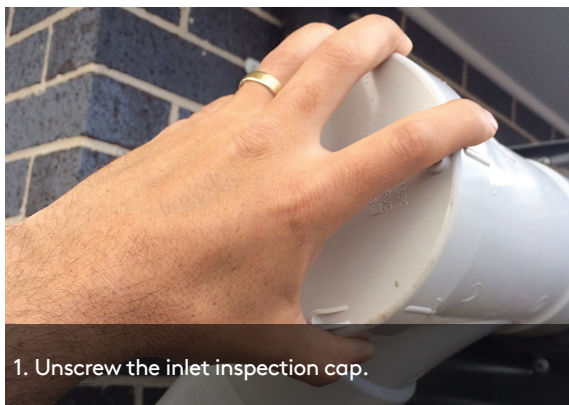

Care and maintenance of your system

High-Flow Filter Sleeve (if fitted)

1. Remove the screw cap from the junction.
2. Gently remove the filter from the housing.
3. Carefully peel back the High-Flow Filter Sleeve off the filter ensuring that the High-Flow Filter Sleeve doesn't catch on the stainless steel filter. Carefully lift the tail of the High-Flow Filter Sleeve over the plastic end piece. Handwash the High-Flow Filter Sleeve with soapy, warm water and dry by hanging out. It's preferable to not use a clothes dryer.
4. To refit the High-Flow Filter Sleeve follow the same process as removing.
 - a. Slide the High-Flow Filter Sleeve onto the end of the filter and tuck the end up against the plastic end piece.
 - b. Carefully pull the High-Flow Filter Sleeve over the stainless steel filter ensuring that the High-Flow Filter Sleeve does not get caught on the mesh.
 - c. Pull the High-Flow Filter Sleeve down until it tucks up against the other end piece.
 - d. Rotate the filter while aligning the High-Flow Filter Sleeve to both plastic end pieces. There should be no visible stainless steel mesh showing.
5. Place the filter with the High-Flow Filter Sleeve fitted back in position, ensuring the handle is in the upper position of the filter housing.

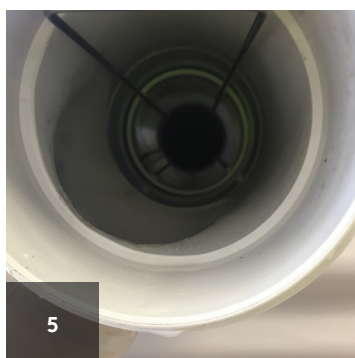
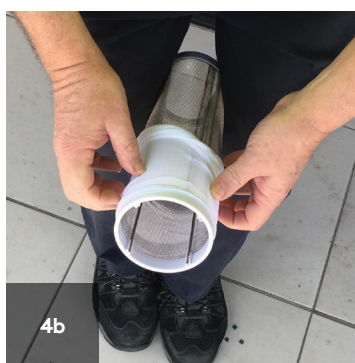
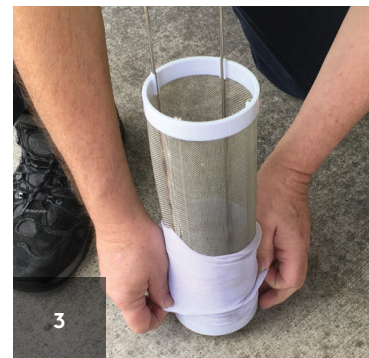

Care and maintenance of your system

Cleaning first flush device (if fitted)

The first flush device is designed to divert the initial water flow away from your tank. This device is optional and may not be installed on your system. If this device has been installed you will find it connected to your charged line or direct feed. Refer to position on diagrams on pages 11 and 12.



ACTION: To check and clean the first flush water diverter, disassemble as shown in the diagram. It may be full of water, so take care when unscrewing the black hose tail. Flush the white strainer and red washer well with clean water. Reassemble, taking care to ensure that the ball is replaced and free to move in the pipe body.

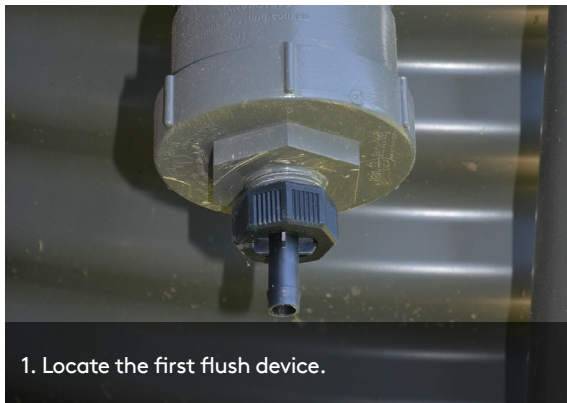

Wall mount classic system Y-strainer



ACTION: turn off pump power, unscrew filter body, remove filter and clean & replace.



Care and maintenance of your system

Cartridge filter (if fitted)

The cartridge filter is designed to have an industry standard 10 inch filter cartridge. Filter cartridges can be purchased from Kingspan, or a plumbing and hardware store. The two filter cartridges available from Kingspan are as follows:

1. 10 micron carbon activated – used to remove colour and odour. This filter cannot be cleaned and has to be replaced when it becomes clogged. Depending on your circumstances this filter needs to be replaced every 6 to 12 months, or when you notice a pressure drop.
2. 50 micron pleated – finer sediment removal down to 50 micron. This filter can be washed and reused. It is recommended that you clean this filter every 6-12 months.



ACTION: Turn off the power point, close mains water valve, unscrew body of cartridge filter, remove cartridge filter and replace it, ensure the cap is tightened.



1. Unscrew body of cartridge filter



2. Remove and replace cartridge filter



3. Screw body of cartridge filter.

Rainwater pipes

Rainwater pipes work to feed the water to your toilets, washing machine and at least one external tap. When your home was built separate water pipes were installed for feeding your toilets, washing machine

(optional) and, one or more, external garden taps. The garden tap that runs from your rainwater tank has a sign indicating rainwater or 'Do Not Drink' symbol.

Water pump + switch

There are number of configurations for the pump and switch, but they all perform the same basic function.

Switch

If there is sufficient water in your tank the switch turns the pump on when water is required. If there is insufficient water in your tank the switch will swap back to mains water automatically. This switch does not add water to your tank, but simply allows the mains water to feed through when your tank is empty.

Pump

The Pump will typically be a sump pump mounted within your tank or, in some cases, an external pump. When the pump is switched on by the controller the tank water is pumped from your tank.

Kingspan supplies one type of pump controller configuration:

A Evolution Series tank mounted system

The Evolution Series comes with a submersible or external pump as an integrated unit. This offers the advantage of when the tank runs out of water, or when there's a power outage the water switch automatically opens the main line to the internal appliances.

The Evolution Series features a changeover device that comfortably sits in the recess of the tank and a quality submersible or external pump.

By integrating your tank with a powerful, high pressure, submersible or external Evolution water tank pump and switch you will enjoy the following benefits:

- » quick and easy to install
- » cost savings through lower power consumption and efficient use of water
- » automatic switching to main water when rainwater runs out or power is off
- » savings on space
- » improved appearance of the system

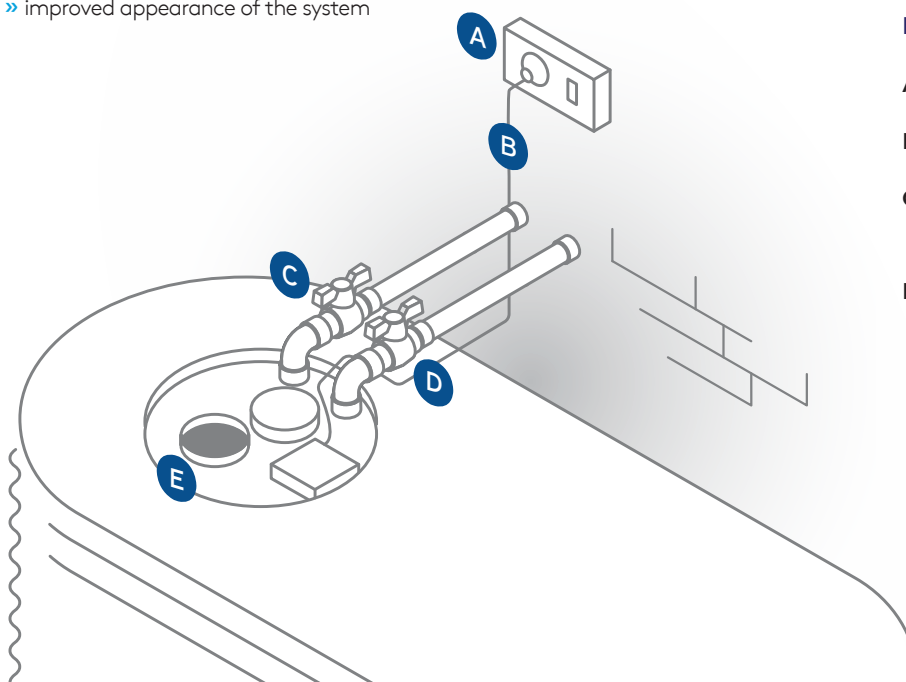

EVO MKIV TANK MOUNTED PUMP

- A.** Weatherproof power outlet
- B.** Power cord
- C.** Mains water IN isolation valve
(shown in ON position)
- D.** Optional Mains/Rain water
OUT isolation valve
(shown in ON position)

Evolution MkIV tank mounted system

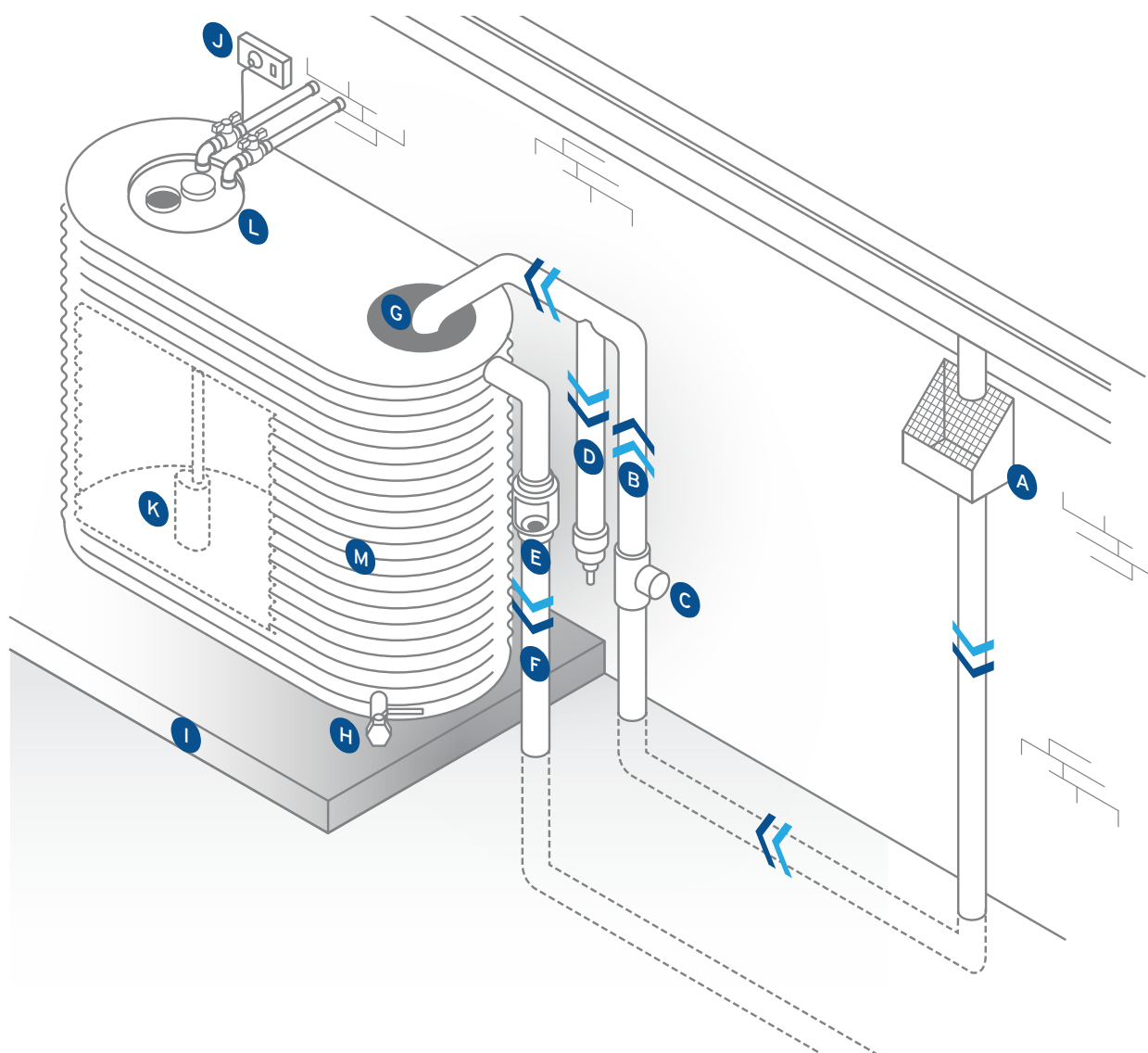

EVO MKIII TANK MOUNTED SYSTEM

- | | | |
|---------------------------------------|---|---|
| A. Leaf eater (optional) | F. Overflow stormwater | K. Submersible pump |
| B. Charged stormwater pipe | G. Inlet screen and light guard | L. Evo MkIV – for detail see p10 |
| C. Inspection outlet | H. Tank drain valve | M. Tank |
| D. First flush water diverter | I. Tank base – concrete or similar | |
| E. Overflow air-gap (optional) | J. Weatherproof power outlet | |

Fault finding

Please use the following guide before making a service call.

FAULT	ACTION
Pump not running	<ul style="list-style-type: none"> » Check water level in tank. Water level must be a minimum of 400mm. » Check power cord plugged in and turned on. » Check power to power point. » Turn the power off for 10 seconds and then pump on again » Pump or controller is faulty. Contact Kingspan on 1300 736 562.
Water overflow from top of tank when raining	<ul style="list-style-type: none"> » Check and clean inlet screen. » Check overflow line is clear. » Call Kingspan on 1300 736 562 if problem persists.
Water leaking from first flush diverter	<ul style="list-style-type: none"> » This is normal and is expected. You will lose a small amount of water while it is raining and for a period after rainfall has stopped. The water can be directed to a drain or similar using 13mm garden hose.
Pump running continuously	<ul style="list-style-type: none"> » Check no leaking taps, hoses, toilet or washing machine connections. » Turn off system and contact Kingspan on 1300 736 562 if problem persists.
Water smells / bad odours	<ul style="list-style-type: none"> » Odour is caused from organic material (leaves and de-bris) in your gutters, pipe work and water tank. » Clean gutters and debris from roof. » Add Rain water tank purifier to your tank. Can be purchased from Kingspan or plumbing and hardware stores. » If problem persist your charged line system may require flushing to remove debris.

Please refer to our website for how to maintenance videos.

Have a service or maintenance problem? Contact us
kingspanwatertanks.com.au | 1300 736 562 | service.au@kingspan.com

Service record

SERVICE PERFORMED	SERVICE DATE
3 year tank service	
6 year tank service	
9 year tank service + tank sanitise clean	
12 year tank service	
15 year tank service	
18 year tank service + tank sanitise clean	

Warranty

- a. All Kingspan rainwater tanks are covered by a 10 year construction warranty.
- b. All tanks made from Bluescope AQUAPLATE® steel are covered by the Bluescope 20 year corrosion warranty.
- c. All pumps and mains water backup controllers are covered by a two year standard warranty issued by the manufacturer.
- d. Warranties do not cover the following:
 - i. Service calls not related to faults with the products included in the rainwater harvesting system.
 - ii. Faults caused by accidental damage, misuse or acts of nature.
 - iii. Maintenance as detailed in this manual.

Tank warranty information can be found at:
kingspanwatertanks.com.au/how-warranty-works

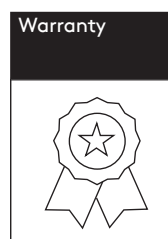

Have a service or maintenance problem? Contact us
kingspanwatertanks.com.au | 1300 736 562 | service.au@kingspan.com



OUR LOCATIONS

We manufacture at each of our three locations:

SYDNEY

3 Herbert Place
Smithfield NSW 2164

MELBOURNE

55 Ricky Way
Epping VIC 3076

BRISBANE

Unit 2/59 Link Drive
Yatala QLD 4207

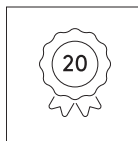

PRODUCT WARRANTY*

With a Kingspan tank, you can rest assured that you have support for the long term. Kingspan Water & Energy Pty Limited warrants the AQUAPLATE® range of steel water tanks as follows:

- 20 year minimum life prior to perforation due to corrosion, as detailed in the AQUAPLATE® product warranty*.
- 10 year construction warranty* covering the assembly and sealing of the tank.



WaterMark

WMTS S062 Licence No 23111
covers Slimline, Modline, Round and Square water tanks.



GOLD MEMBER

Fire Protection
Association Australia



A DIVISION OF IRRIGATION AUSTRALIA

**AUSTRALIAN®
WATER**

ASSOCIATION

1300 736 562

kingspanwatertanks.com.au
sales.au@kingspan.com

We take every care to ensure that the information in this document is accurate at the point of publication. Specification may vary (within a small parameter) due to manufacturing process variations or environmental conditions. All images are for illustration purposes only and should not be taken as binding. The actual product may vary, and specification/dimensions/colour/other attributes may differ.

To ensure you are viewing the most recent and accurate product information, please visit this link:
www.kingspanwatertanks.com.au/urbanownersmanual

©Kingspan and the Lion Device are Registered Trademarks of the Kingspan Group plc in the UK, Ireland and other countries. All rights reserved.

Registered Office: Kingspan Water & Energy Pty Limited,
3 Herbert Place, Smithfield, NSW 2164

Version 3 | 03/2024